

Toothed drive belt, assembly

1 - Bolt

- ◆ 70 Nm (52 ft lb)

2 - Locking plate

- ◆ Side with inscribed lettering always faces camshaft

3 - Camshaft sprocket

- ◆ Removing ⇒ [page 13-12](#)
- ◆ Tighten camshaft sprockets after toothed belt tension is adjusted

CAUTION!

- ◆ **Camshaft holder 3243 must be installed before attaching camshaft sprockets.**
- ◆ **Do not tighten the camshaft sprockets until after toothed belt tension has been adjusted.**

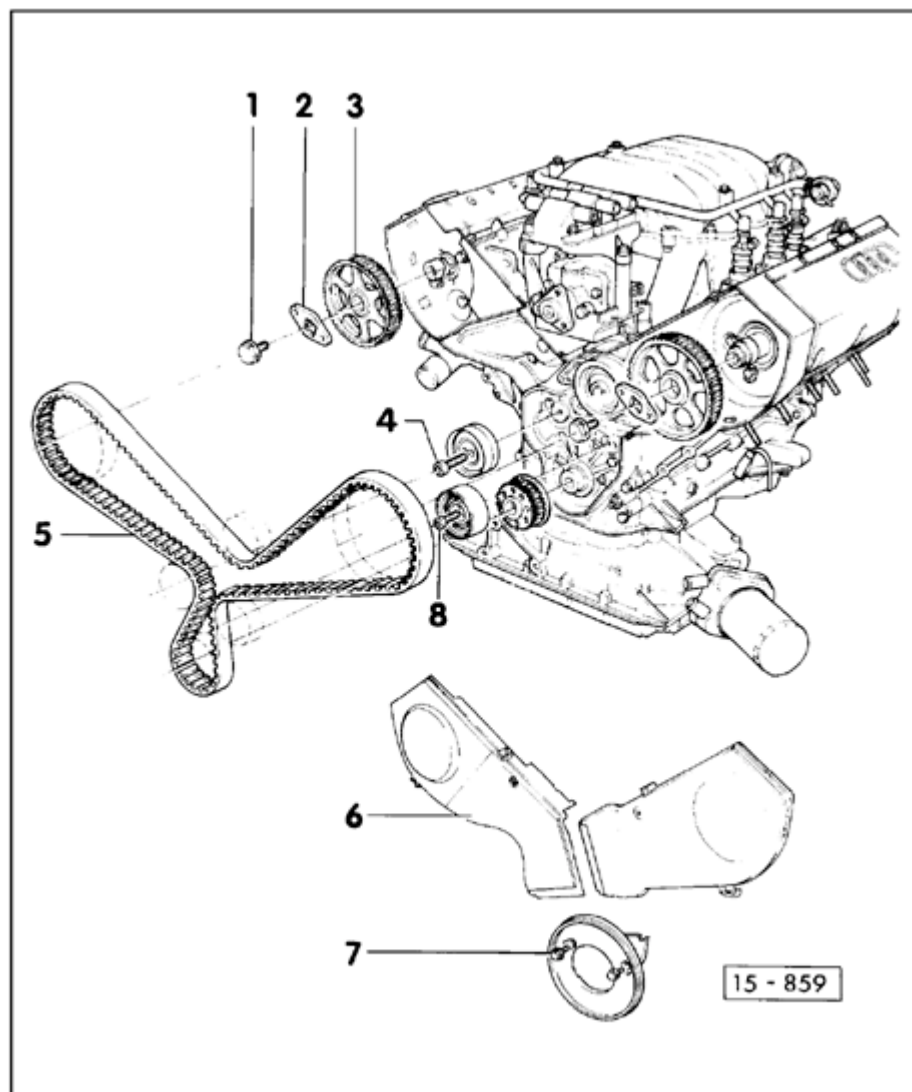
**4 - Toothed belt tensioner**

◆ 45 Nm (33 ft lb)

5 - Toothed belt

◆ Removing and installing ⇒ [page 13-11](#)

6 - Toothed belt cover

7 - 10 Nm (7 ft lb)

8 - 25 Nm (18 ft lb)