

Exhaust system components, removing and installing

Note:

- ◆ *As a general rule, always install new seals and gaskets and clamping sleeves.*
- ◆ *Always replace self-locking nuts.*
- ◆ *Install retaining rings and bolted connections as specified ⇒ Parts catalog microfiche.*
- ◆ *Make sure that there is adequate clearance between the body and the exhaust system components.*

Instructions for aligning the exhaust system free of stress will be issued in a subsequent Technical Bulletin.

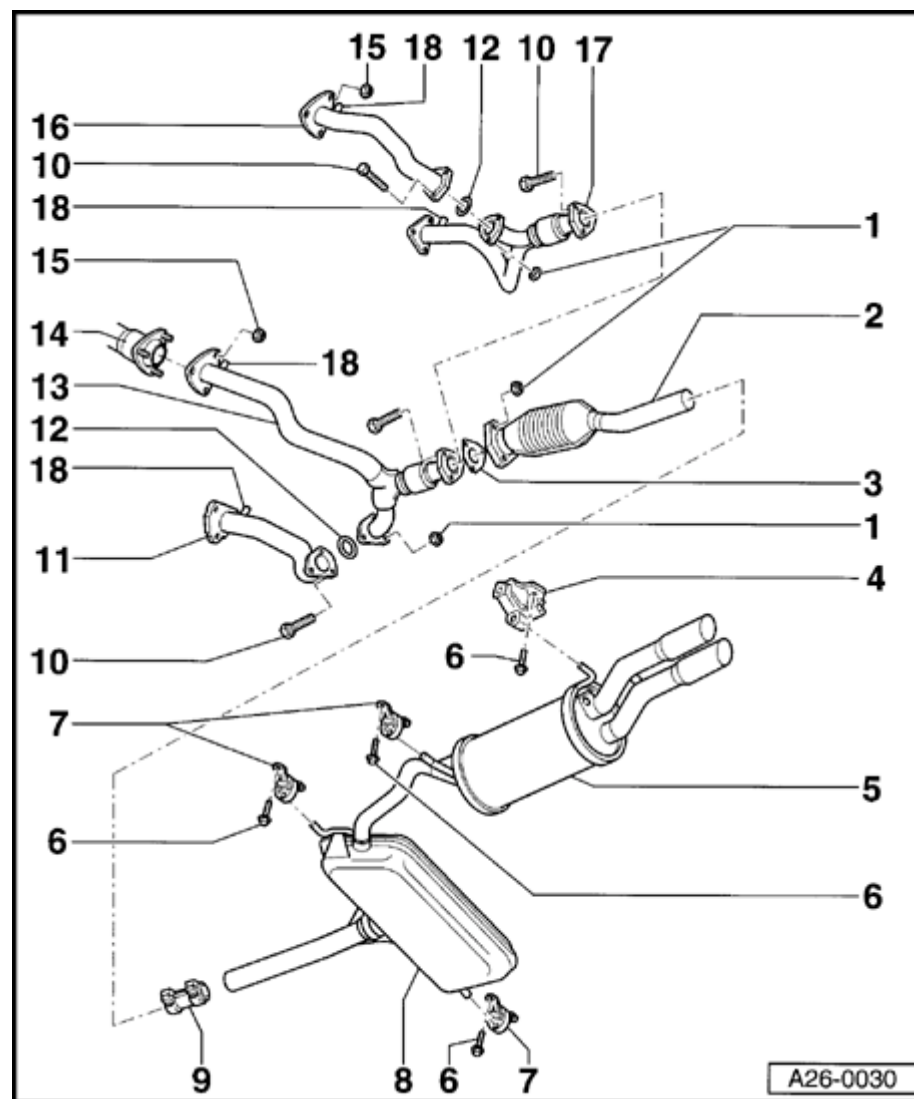

Front-wheel-drive, engine code AFC

1 - Locking nut

◆ 25 Nm (18 ft lb)

2 - Three Way Catalytic Converter (TWC)

3 - Gasket

4 - Retaining ring

◆ When replacing always use a lubricant and avoid damaging the rubber.

5 - Rear muffler

6 - Hex bolt

◆ 25 Nm (18 ft lb)

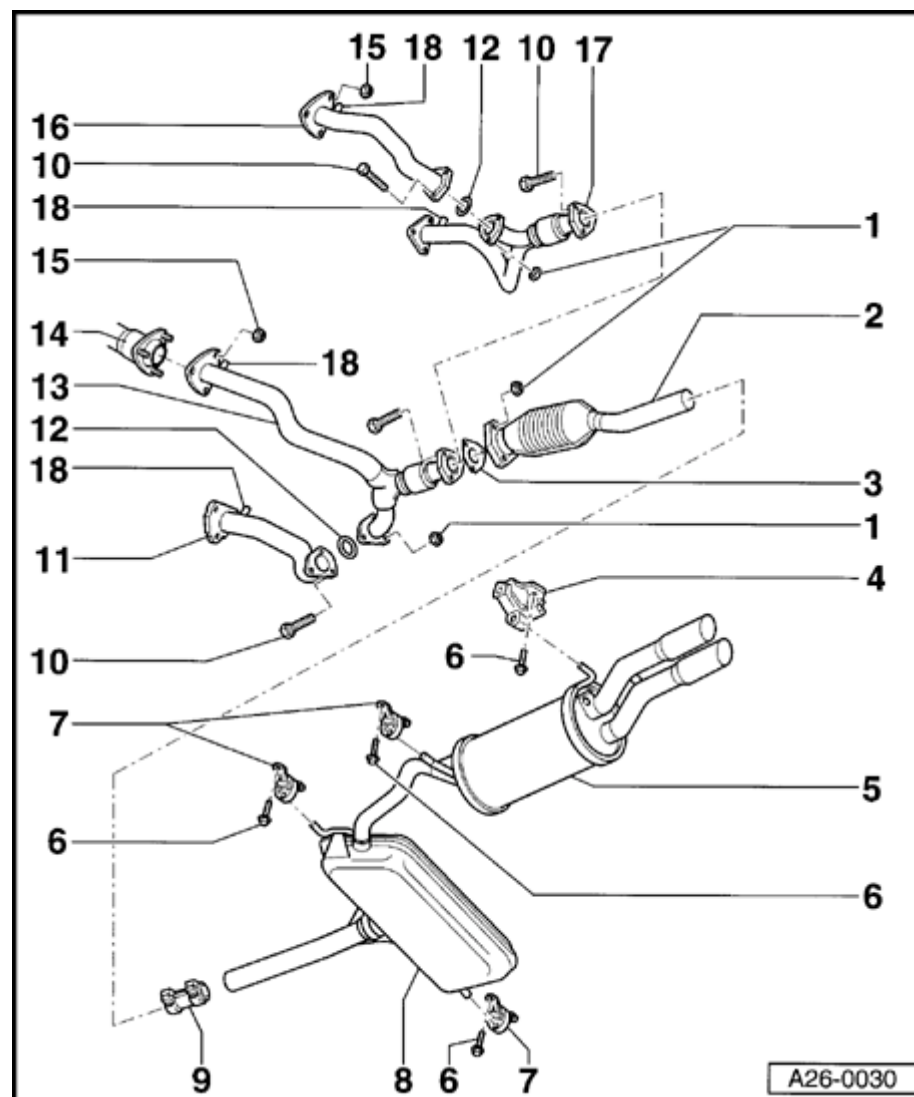

7 - Retaining ring

8 - Center muffler

9 - Clamping sleeve

◆ 40 Nm (30 ft lb)

◆ Tighten evenly

◆ Installed horizontally in vehicle

10 - Hex bolt

11 - Exhaust pipe, right front

◆ Only for models with automatic transmission

12 - Seal

13 - Exhaust pipe with insulating element, left front

◆ Only for models with automatic transmission

Note:

Handle the insulating elements with care; protect from shock-like stresses and extreme bending. Maximum deflection 10°.

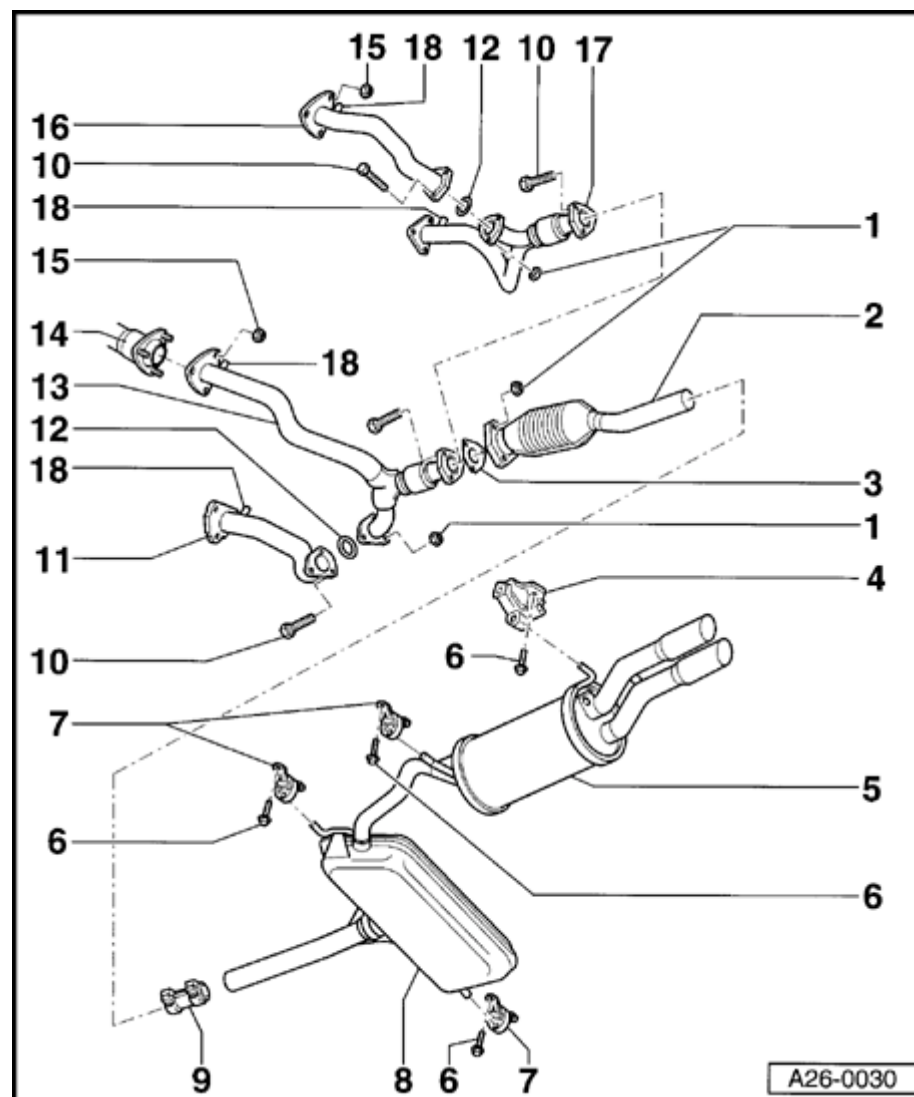

14 - Exhaust manifold

15 - Hex nut

◆ 30 Nm (22 ft lb)

16 - Exhaust pipe, left front

17 - Exhaust pipe with insulating element, right front

18 - Heated Oxygen Sensor (HO2S)

◆ 50 Nm (37 ft lb)

◆ Testing ⇒ Repair Manual, 2.8 Liter V6
OBD II Fuel Injection & Ignition, Repair
Group 24

◆ Lubricate threads with G5

◆ G5 must not get into slots on HO2S probe
body

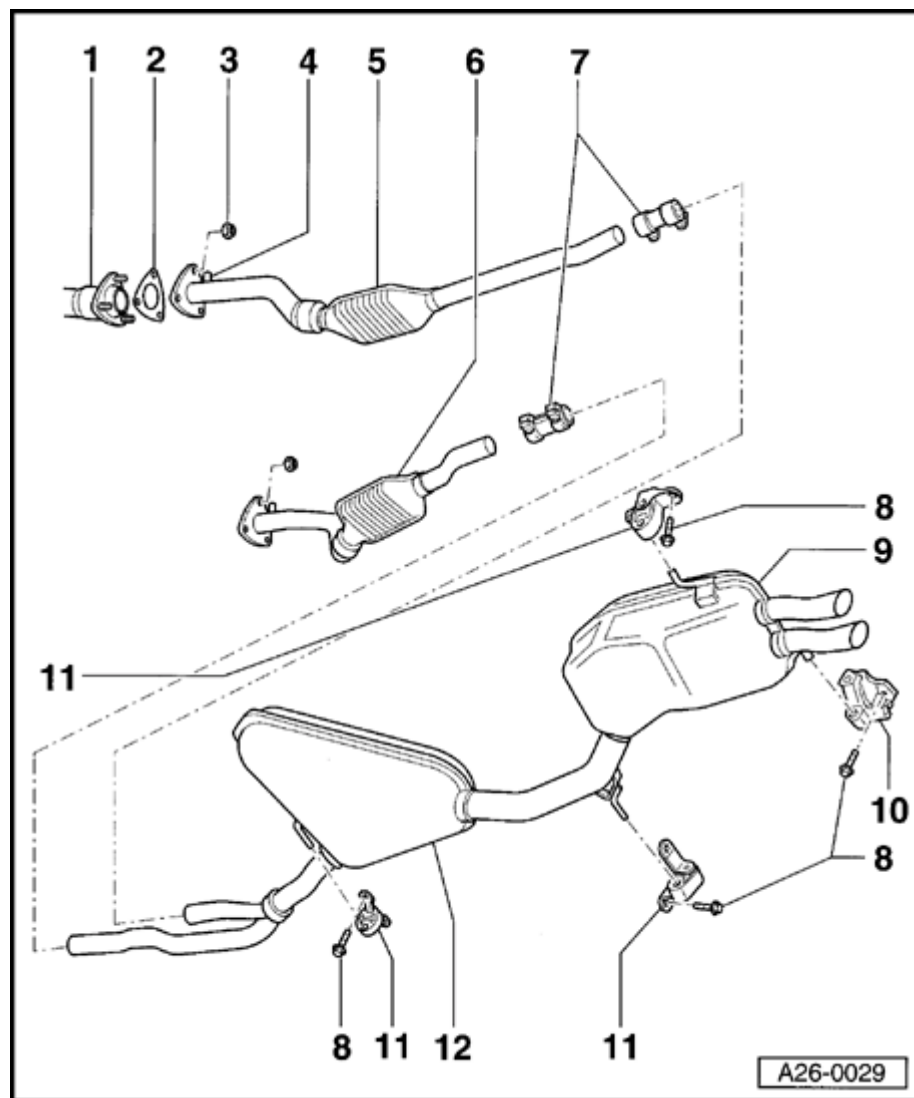

All-wheel-drive, engine codes AFC

1 - Exhaust manifold

2 - Gasket

3 - Hex nut

◆ 30 Nm (22 ft lb)

4 - Heated Oxygen Sensor (HO2S)

◆ 50 Nm (37 ft lb)

◆ Testing ⇒ Repair Manual, 2.8 Liter V6
OBD II Fuel Injection & Ignition, Repair
Group 24

◆ Lubricate threads with G5

◆ G5 must not get into slots on HO2S probe
body

**5 - Three Way Catalytic Converter (TWC) with
insulating element, left**

Note:

*Handle the insulating elements with care; protect
from shock-like stresses and extreme bending.
Maximum deflection 10°.*

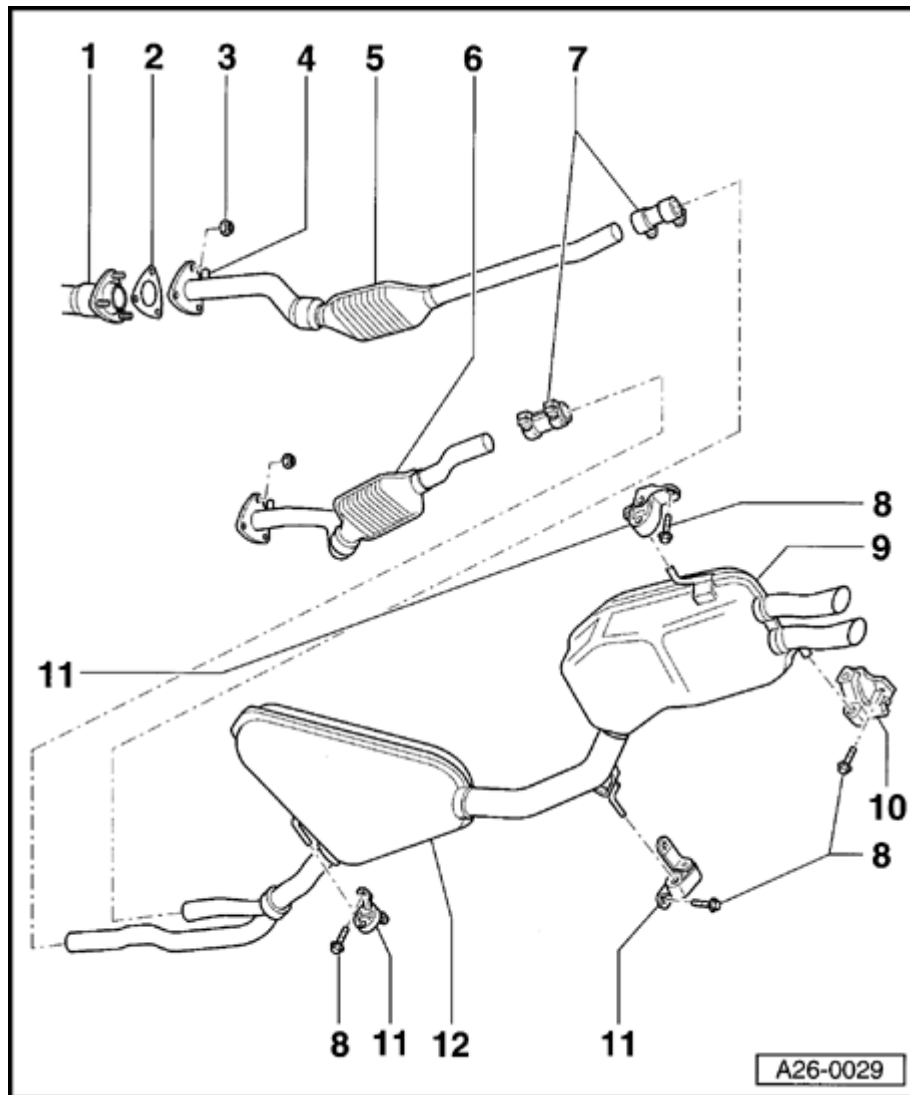

6 - Three Way Catalytic Converter (TWC) with insulating element, right

7 - Clip

◆ 40 Nm (30 ft lb)

8 - Hex bolt

◆ 25 Nm (18 ft lb)

9 - Rear muffler

10 - Retaining ring

◆ When replacing always use a lubricant and avoid damaging the rubber.

11 - Retaining ring

◆ When replacing always use a lubricant and avoid damaging the rubber.

12 - Center muffler